

1

2

3

4

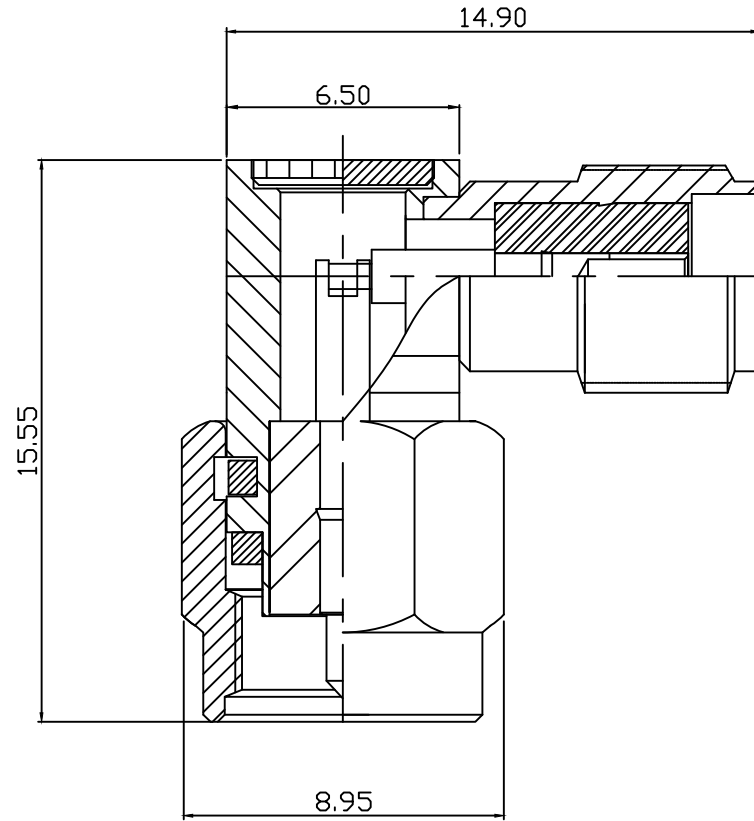

NOTE :

1. Material and Finish

Center contact : Brass / Gold

Center contact : Beryllium Copper / Gold

Body, : Brass / Gold

Insulator : PTFE

SMA Cap : Brass / Gold

Gasket : Silicone-rubber

2. Specification

IMPEDANCE : 50 Ω

Frequency range : DC~18 GHz

VSWR 1.10 : 1 Max. @ DC ~ 5GHz

1.20 : 1 Max. @ 5 ~ 6.2GHz

Operating temperature range : -65° C ~ 125° C

2011/65/EU (RoHS) : Compliant

부품번호	생산업체 명(국가명),주소	생산자 부호
CM-408-006	알에프씨엠(KR) 충청북도 진천군 진천읍 농다리로 1434 043-533-4546	

DATE	2022.10.4	품 번 :	CM-408-006	품 명 : -
UNIT	MM	TOLERANCE	±0.05	SMA(M) R/A SMA(F) ADAPTOR
SIZE	A4	SCALE	n/1	MIN KI HONG
				RFCM

1

2

3

4